

**2017 ANNUAL GROUNDWATER MONITORING AND CORRECTIVE ACTION REPORT**

**Weston Disposal Site No. 3 Landfill  
Town of Knowlton, Wisconsin**

**Wisconsin Public Service Corporation**

January 31, 2018



JANUARY 31, 2018 | PROJECT #67985

# 2017 Annual Groundwater Monitoring and Corrective Action Report

Weston Disposal Site No. 3 Landfill

Town of Knowlton, Wisconsin

Prepared for:

*WEC Business Services, LLC*  
333 W. Everett Street  
Milwaukee, WI



---

KRISTEN L. THEESFELD  
Hydrogeologist



---

GLENN R. LUKE, PE  
Managing Engineer

## TABLE OF CONTENTS

---

<b>TABLES</b> .....	<b>ii</b>
<b>FIGURES</b> .....	<b>ii</b>
<b>ACRONYMS AND ABBREVIATIONS</b> .....	<b>iii</b>
<b>1 INTRODUCTION</b> .....	<b>1</b>
1.1 Overview .....	1
1.2 Monitoring and Corrective Action Program Status .....	1
<b>2 KEY ACTIONS COMPLETED IN 2017</b> .....	<b>2</b>
2.1 Summary.....	2
2.2 Problems Encountered and Actions to Resolve Problems .....	2
<b>3 KEY ACTIVITIES PLANNED FOR 2018</b> .....	<b>3</b>
3.1 Summary.....	3
<b>REFERENCES</b> .....	<b>4</b>



## TABLES

---

Table 1	Weston Disposal Site No. 3 Landfill: Appendix III Analytical Results
Table 2	Weston Disposal Site No. 3 Landfill: Appendix IV Analytical Results

## FIGURES

---

Figure 1	Groundwater Sampling Well Location Map
----------	--

## ACRONYMS AND ABBREVIATIONS

---

CCR	Coal Combustion Residuals
CFR	Code of Federal Regulations
mg/L	milligrams per liter
OBG	O'Brien & Gere Engineers, Inc.
SSI	Statistically Significant Increase
STD	standard units
WDS3	Weston Disposal Site No. 3

## 1 INTRODUCTION

### 1.1 OVERVIEW

This report has been prepared on behalf of Wisconsin Public Service Corporation (WPSC) by O'Brien & Gere Engineers, Inc. (OBG), to provide the information required by Title 40 of the Code of Federal Regulations (40 CFR) Part 257.90(e) for the Weston Disposal Site No. 3 (WDS3) Landfill located in the Town of Knowlton, Wisconsin.

In accordance with 40 CFR 257.90(e), the owner or operator of an existing coal combustion residual (CCR) unit must prepare an annual groundwater monitoring and corrective action report (Annual Report) for the preceding calendar year. The Annual Report must document the status of the groundwater monitoring and corrective action program for the CCR unit and summarize key actions completed, describe any problems encountered, discuss actions to resolve the problems, and project key activities for the upcoming year. At a minimum, the Annual Report must contain the following information, to the extent available:

- (1) A map, aerial image, or diagram showing the CCR unit and all background (or upgradient) and downgradient monitoring wells, to include the well identification numbers, that are part of the groundwater monitoring program for the CCR unit;
- (2) Identification of any monitoring wells that were installed or decommissioned during the preceding year, along with a narrative description of why those actions were taken;
- (3) In addition to all the monitoring data obtained under 40 CFR 257.90 through 257.98, a summary including the number of groundwater samples that were collected for analysis for each background and downgradient well, the dates the samples were collected, and whether the sample was required by the detection monitoring or assessment monitoring programs;
- (4) A narrative discussion of any transition between monitoring programs (*e.g.*, the date and circumstances for transitioning from detection monitoring to assessment monitoring in addition to identifying the constituent(s) detected at a statistically significant increase over background levels); and
- (5) Other information required to be included in the annual report as specified in 40 CFR 257.90 through 257.98.<sup>1</sup>

This report provides the required information for the WDS3 Landfill for calendar year 2017.

### 1.2 MONITORING AND CORRECTIVE ACTION PROGRAM STATUS

The final two independent samples of the minimum eight required by 40 CFR 257.94(b) were collected and analyzed from each background and downgradient well before October 17, 2017. The other six independent samples were collected and analyzed in 2016.

The first semi-annual monitoring sample for the Detection Monitoring Program was collected on October 11, 2017 from each well; the analytical data was received on October 26, 2017.

The collection of eight independent background samples and the first semi-annual detection monitoring event for Appendix III parameters were completed by October 17, 2017. Determination of statistically significant increases (SSI) of Appendix III parameters over background concentrations will be completed within 90 days of completing sample analysis, but not later than January 15, 2018.

---

<sup>1</sup> For calendar year 2017, corrective action and other information required to be included in the annual report as specified in 40CFR 257.90 through 257.98 is not applicable.

## 2 KEY ACTIONS COMPLETED IN 2017

---

### 2.1 SUMMARY

Two groundwater sampling events were completed in 2017 as part of an effort initiated in 2016 to collect eight independent samples from background and downgradient monitoring wells in accordance with 40 CFR 257.94(b).

Subsequent to collection of the eight independent samples, an additional sampling event was completed in October 2017 for parameters listed in Appendix III, 40 CFR Part 257, to supplement the background data set and as the first semi-annual monitoring sampling event for the Detection Monitoring Program.

A map showing the groundwater monitoring system, including the CCR unit and all background (upgradient) and downgradient monitoring wells with well identification numbers, for the WDS3 Landfill is presented in Figure 1. No monitoring wells were installed or decommissioned from the monitoring system in 2017.

All monitoring data obtained under 40 CFR 257.90 through 257.98 (as applicable) in 2017, as well as monitoring data for the previously collected six independent samples are presented in Tables 1 and 2. Sample collection dates in 2017 were March 10, June 2, and October 11. Sample collection dates for previously collected six independent samples are identified in Tables 1 and 2. One ground water sample was collected from each background and downgradient well in each sampling event.

During the February 18, 2016 sampling event at WDS3 landfill the water quality probe malfunctioned during sample collection and field parameters, inclusive of specific conductance, pH, temperature, dissolved oxygen, oxidation-reduction potential, and turbidity, were not obtained.

Statistical evaluation of analytical data from the eight independent samples required to be collected by October 17, 2017 and the first semi-annual detection monitoring event on October 11, 2017 was initiated and will be completed within 90 days of October 17, 2017 (January 15, 2018). Statistical evaluation of analytical data is being performed in accordance with the Statistical Analysis Plan, WDS3 Landfill (Natural Resource Technology, an OBG Company, 2017).

### 2.2 PROBLEMS ENCOUNTERED AND ACTIONS TO RESOLVE PROBLEMS

No problems were encountered with the groundwater monitoring program during 2017 and all data was accepted.

### 3 KEY ACTIVITIES PLANNED FOR 2018

---

#### 3.1 SUMMARY

The following key activities are planned for 2018:

- Continuation of the Detection Monitoring Program with semi-annual sampling scheduled for the 2<sup>nd</sup> and 4<sup>th</sup> quarters of 2018.
- Complete evaluation of analytical data from the downgradient wells, using both the eight samples required to be collected by October 17, 2017 and the first semi-annual detection monitoring sample taken in October 2017 to determine whether a SSI of Appendix III parameters over background concentrations has occurred.
- If an SSI is identified, potential alternate sources (*i.e.*, a source other than the CCR unit caused the SSI or that that SSI resulted from error in sampling, analysis, statistical evaluation, or natural variation in groundwater quality) will be evaluated. If an alternate source is demonstrated to be the cause of the SSI, a written demonstration will be completed within 90 days of SSI detection and included in the annual groundwater monitoring and corrective action report for 2018.
  - » If an alternate source(s) is not identified to be the cause of the SSI, the applicable requirements of 40 CFR 257.94 through 257.98 (*e.g.*, assessment monitoring) will apply in 2018, including associated recordkeeping/notifications required by 40 CFR 257.105 through 257.108.



## REFERENCES

---

Natural Resource Technology, an OBG Company, 2017, Statistical Analysis Plan, Weston Disposal Site No. 3 Landfill, Town of Knowlton, Wisconsin, October 17, 2017.





## Tables

**Weston Disposal Site #3**  
**Table 1. Weston Disposal Site No. 3 Landfill: Appendix III Analytical Results**

Date Range: 02/18/2016 to 10/11/2017

Well Id	Date Sampled	Lab Id	B, tot, mg/L	Ca, tot, mg/L	Cl, tot, mg/L	F, tot, mg/L	pH (field), STD	SO4, tot, mg/L
LS-100	02/18/2016	40128408001	0.0480	13.900	4.000	<0.200		12.500
	04/05/2016	40130257002	0.0120	27.300	4.300	<0.200	6.460	16.600
	06/15/2016	40133877003	0.0350	22.500	3.600	<0.200	6.530	13.100
	08/10/2016	40136543003	0.0410	28.200	4.900	<0.200	6.620	20.700
	10/05/2016	40139741002	0.1000	56.800	0.970	<0.100	6.620	4.500
	12/21/2016	40143755003	0.0980	75.200	21.000	<0.100	7.110	202.000
	03/10/2017	40146662002	0.0290	17.900	3.600	<0.100	8.390	30.000
	06/02/2017	40151013002	0.1100	13.100	1.600	<0.100	8.030	31.500
	10/11/2017	40158568002	0.0559	11.000	0.860	<0.100	6.270	15.700
LS-101	02/18/2016	40128408002	0.0086	5.200	2.900	<0.200		5.600
	04/05/2016	40130257003	0.0096	3.400	2.300	<0.200	6.230	5.600
	06/15/2016	40133877002	0.0097	4.700	2.600	<0.200	6.280	4.800
	08/10/2016	40136543002	0.0140	11.600	2.400	<0.200	6.400	4.100
	10/05/2016	40139741003	0.0120	6.800	2.000	<0.100	6.760	13.300
	12/21/2016	40143755002	0.0120	6.900	0.820	<0.100	6.990	4.300
	03/10/2017	40146662003	0.0092	3.300	<0.500	<0.100	7.470	4.400
	06/02/2017	40151013003	0.0430	2.500	0.720	<0.100	7.800	4.100
	10/11/2017	40158568003	0.0138	11.400	0.760	<0.100	5.750	5.900
LS-105	02/18/2016	40128408003	0.0140	17.300	4.200	<0.200		9.200
	04/05/2016	40130257004	0.0140	14.200	3.500	<0.200	6.500	10.000
	06/15/2016	40133877004	0.0130	14.300	3.500	<0.200	6.500	9.100
	08/10/2016	40136543004	0.0200	20.100	2.900	<0.200	6.740	4.800
	10/05/2016	40139741004	0.0300	31.400	12.400	<1.000	7.070	67.800
	12/21/2016	40143755005	0.0300	34.000	10.600	<0.500	7.450	58.600
	03/10/2017	40146662004	0.0260	32.300	7.200	<0.100	7.820	50.400
	06/02/2017	40151013004	0.0330	14.200	2.600	<0.100	7.900	26.500
	10/11/2017	40158568004	0.0452	18.800	3.600	<0.500	7.240	31.000
LS-106	02/18/2016	40128408004	0.0150	9.200	4.200	<0.200		6.700
	04/05/2016	40130257005	0.0890	7.700	3.200	<0.200	6.700	6.600
	06/15/2016	40133877005	0.0540	7.600	3.200	<0.200	6.520	5.500
	08/10/2016	40136543005	0.0630	10.100	<10.000	<1.000	6.640	<10.000
	10/05/2016	40139741005	0.3600	10.700	2.800	<0.500	7.020	<5.000
	12/21/2016	40143755006	0.1200	12.300	<2.500	<0.500	7.500	5.700
	03/10/2017	40146662005	0.4500	9.900	<2.500	<0.500	8.080	5.200
	06/02/2017	40151013005	0.0910	9.400	4.100	<0.500	7.950	11.800
	10/11/2017	40158568005	0.1060	15.500	3.600	<0.500	6.580	11.400

**Weston Disposal Site #3**  
**Table 1. Weston Disposal Site No. 3 Landfill: Appendix III Analytical Results**

**Date Range: 02/18/2016 to 10/11/2017**

			B, tot, mg/L	Ca, tot, mg/L	Cl, tot, mg/L	F, tot, mg/L	pH (field), STD	SO4, tot, mg/L
LS-107	02/18/2016	40128408005	0.0100	17.000	9.400	<0.200		9.000
	04/05/2016	40130257006	0.0097	18.200	7.400	<0.200	6.220	9.200
	06/15/2016	40133877001	0.0089	19.100	7.900	<0.200	6.520	10.800
	08/10/2016	40136543001	0.0120	21.000	6.900	<0.200	6.710	10.000
	10/05/2016	40139741006	0.0120	22.000	5.400	<0.100	6.830	10.000
	12/20/2016	40143755001	0.0140	25.900	4.700	<0.100	7.160	12.500
	03/10/2017	40146662006	0.0110	25.700	3.800	<0.100	7.420	15.200
	06/02/2017	40151013006	0.0310	21.900	5.400	<0.100	7.580	19.900
	10/11/2017	40158568006	0.0143	26.000	6.200	<0.100	6.130	25.500

**Weston Disposal Site #3**  
**Table 1. Weston Disposal Site No. 3 Landfill: Appendix III Analytical Results**

**Date Range: 02/18/2016 to 10/11/2017**

Well Id	Date Sampled	Lab Id	TDS, mg/L
LS-100	02/18/2016	40128408001	122.000
	04/05/2016	40130257002	150.000
	06/15/2016	40133877003	148.000
	08/10/2016	40136543003	182.000
	10/05/2016	40139741002	306.000
	12/21/2016	40143755003	360.000
	03/10/2017	40146662002	98.000
	06/02/2017	40151013002	94.000
	10/11/2017	40158568002	80.000
LS-101	02/18/2016	40128408002	50.000
	04/05/2016	40130257003	52.000
	06/15/2016	40133877002	44.000
	08/10/2016	40136543002	84.000
	10/05/2016	40139741003	70.000
	12/21/2016	40143755002	60.000
	03/10/2017	40146662003	28.000
	06/02/2017	40151013003	30.000
	10/11/2017	40158568003	62.000
LS-105	02/18/2016	40128408003	98.000
	04/05/2016	40130257004	94.000
	06/15/2016	40133877004	80.000
	08/10/2016	40136543004	148.000
	10/05/2016	40139741004	204.000
	12/21/2016	40143755005	196.000
	03/10/2017	40146662004	178.000
	06/02/2017	40151013004	96.000
	10/11/2017	40158568004	100.000
LS-106	02/18/2016	40128408004	70.000
	04/05/2016	40130257005	94.000
	06/15/2016	40133877005	110.000
	08/10/2016	40136543005	94.000
	10/05/2016	40139741005	228.000
	12/21/2016	40143755006	186.000
	03/10/2017	40146662005	544.000
	06/02/2017	40151013005	72.000
	10/11/2017	40158568005	108.000

**Weston Disposal Site #3**  
**Table 1. Weston Disposal Site No. 3 Landfill: Appendix III Analytical Results**

---

**Date Range: 02/18/2016 to 10/11/2017**

			<b>TDS, mg/L</b>
LS-107	02/18/2016	40128408005	88.000
	04/05/2016	40130257006	94.000
	06/15/2016	40133877001	112.000
	08/10/2016	40136543001	118.000
	10/05/2016	40139741006	118.000
	12/20/2016	40143755001	72.000
	03/10/2017	40146662006	134.000
	06/02/2017	40151013006	110.000
	10/11/2017	40158568006	134.000

**Weston Disposal Site #3**  
**Table 2. Weston Disposal Site No. 3 Landfill: Appendix IV Analytical Results**

Date Range: 02/18/2016 to 10/01/2017

Well Id	Date Sampled	Lab Id	As, tot, mg/L	Ba, tot, mg/L	Be, tot, mg/L	Cd,tot, mg/L	Co, tot, mg/L	Cr, tot, mg/L
LS-100	02/18/2016	40128408001	0.000500	0.028400	0.000270	<0.000027	0.001300	0.00520
	04/05/2016	40130257002	<0.000730	0.028800	<0.000042	<0.000025	0.000160	0.00056
	06/15/2016	40133877003	0.000370	0.032800	0.000150	<0.000089	0.000700	0.00290
	08/10/2016	40136543003	0.000520	0.042600	0.000190	<0.000089	0.000540	0.00270
	10/05/2016	40139741002	0.000650	0.109000	<0.000130	<0.000089	0.001000	0.00100
	12/21/2016	40143755003	0.000760	0.128000	<0.000130	0.000094	0.000300	0.00160
	03/10/2017	40146662002	0.000260	0.022000	<0.000130	0.000090	0.000250	0.00130
	06/02/2017	40151013002	0.000520	0.025000	<0.001200	<0.001300	<0.001400	<0.00250
LS-101	02/18/2016	40128408002	<0.000110	0.018500	<0.000045	<0.000027	0.000079	0.00025
	04/05/2016	40130257003	<0.000730	0.020700	<0.000042	<0.000025	0.000150	0.00068
	06/15/2016	40133877002	0.000180	0.023900	<0.000130	<0.000089	0.000081	<0.00039
	08/10/2016	40136543002	0.000270	0.052500	<0.000130	<0.000089	0.000087	0.00044
	10/05/2016	40139741003	<0.000099	0.032700	<0.000130	<0.000089	0.000061	<0.00039
	12/21/2016	40143755002	0.000200	0.027300	<0.000130	<0.000089	0.000110	0.00042
	03/10/2017	40146662003	0.000230	0.018800	<0.000130	<0.000089	0.000170	0.00110
	06/02/2017	40151013003	<0.000280	0.015400	<0.001200	<0.001300	<0.001400	<0.00250
LS-105	02/18/2016	40128408003	0.001900	0.036800	0.000150	<0.000027	0.012400	0.00190
	04/05/2016	40130257004	0.001000	0.023900	0.000065	<0.000025	0.009400	0.00049
	06/15/2016	40133877004	0.001300	0.025700	<0.000130	<0.000089	0.010200	0.00048
	08/10/2016	40136543004	0.002300	0.035800	<0.000130	<0.000089	0.013600	0.00100
	10/05/2016	40139741004	0.002400	0.056200	<0.000130	<0.000089	0.015700	0.00051
	12/21/2016	40143755005	0.002000	0.055400	<0.000130	<0.000089	0.018500	0.00067
	03/10/2017	40146662004	0.001600	0.049500	<0.000130	<0.000089	0.018300	0.00084
	06/02/2017	40151013004	0.001600	0.027000	<0.001200	<0.001300	0.007600	<0.00250
LS-106	02/18/2016	40128408004	0.001500	0.061200	0.000310	<0.000027	0.005600	0.00660
	04/05/2016	40130257005	0.002600	0.084800	0.000740	0.000049	0.009400	0.02340
	06/15/2016	40133877005	0.002000	0.055400	0.000320	<0.000089	0.008500	0.00920
	08/10/2016	40136543005	0.001600	0.054800	0.000170	<0.000089	0.006000	0.00630
	10/05/2016	40139741005	0.006400	0.198000	0.002100	<0.000180	0.016400	0.05810
	12/21/2016	40143755006	0.002200	0.090000	0.000740	<0.000089	0.009300	0.01850
	03/10/2017	40146662005	0.005900	0.179000	0.002400	<0.000440	0.018400	0.06320
	06/02/2017	40151013005	0.003000	0.063500	<0.001200	<0.001300	0.007200	0.01090
LS-107	02/18/2016	40128408005	0.000200	0.049100	<0.000045	<0.000027	0.000540	0.00050
	04/05/2016	40130257006	<0.000730	0.036900	<0.000042	<0.000025	0.000140	0.00022
	06/15/2016	40133877001	0.000160	0.041600	<0.000130	<0.000089	0.000200	<0.00039
	08/10/2016	40136543001	0.000120	0.045700	0.000190	<0.000089	0.000140	0.00054

**Weston Disposal Site #3**  
**Table 2. Weston Disposal Site No. 3 Landfill: Appendix IV Analytical Results**

**Date Range: 02/18/2016 to 10/01/2017**

			As, tot, mg/L	Ba, tot, mg/L	Be, tot, mg/L	Cd,tot, mg/L	Co, tot, mg/L	Cr, tot, mg/L
LS-107	10/05/2016	40139741006	<0.000099	0.046900	<0.000130	<0.000089	0.000092	<0.00039
	12/20/2016	40143755001	0.000250	0.054100	0.000390	0.000270	0.000500	0.00054
	03/10/2017	40146662006	<0.000099	0.051000	<0.000130	<0.000089	0.000240	0.00100
	06/02/2017	40151013006	<0.000280	0.045800	<0.001200	<0.001300	<0.001400	<0.00250



**Weston Disposal Site #3**  
**Table 2. Weston Disposal Site No. 3 Landfill: Appendix IV Analytical Results**

Date Range: 02/18/2016 to 10/01/2017

Well Id	Date Sampled	Lab Id	F, tot, mg/L	Hg, tot, mg/L	Li, tot, mg/L	Mo, tot, mg/L	Pb, tot, mg/L	Ra 226+228, PCi/L
LS-100	02/18/2016	40128408001	<0.200	<0.00010	0.00190	0.000310	0.000780	1.0030
	04/05/2016	40130257002	<0.200	<0.00010	0.00044	0.000360	0.000130	1.3900
	06/15/2016	40133877003	<0.200	<0.00013	0.00100	0.000330	0.000230	0.7240
	08/10/2016	40136543003	<0.200	<0.00013	0.00099	0.000250	0.000130	0.3600
	10/05/2016	40139741002	<0.100	<0.00013	0.00051	0.000085	0.000044	1.1190
	12/21/2016	40143755003	<0.100	<0.00013	0.00066	0.000180	0.000160	0.6950
	03/10/2017	40146662002	<0.100	<0.00013	0.00045	0.000870	0.000180	0.3260
	06/02/2017	40151013002	<0.100	<0.00013	0.00120	<0.001400	0.000440	0.9960
LS-101	02/18/2016	40128408002	<0.200	<0.00010	0.00031	0.000085	0.000100	1.5280
	04/05/2016	40130257003	<0.200	<0.00010	0.00040	0.000410	0.000170	0.3310
	06/15/2016	40133877002	<0.200	<0.00013	0.00020	<0.000070	0.000068	1.5770
	08/10/2016	40136543002	<0.200	<0.00013	0.00054	0.000240	0.000044	0.5270
	10/05/2016	40139741003	<0.100	<0.00013	0.00029	0.000083	<0.000040	1.1990
	12/21/2016	40143755002	<0.100	<0.00013	0.00043	0.000130	0.000057	0.2260
	03/10/2017	40146662003	<0.100	<0.00013	0.00024	0.000150	0.000140	0.1930
	06/02/2017	40151013003	<0.100	<0.00013	0.00025	<0.001400	<0.000200	0.3750
LS-105	02/18/2016	40128408003	<0.200	<0.00010	0.00200	0.000200	0.001100	0.3420
	04/05/2016	40130257004	<0.200	<0.00010	0.00054	0.000160	0.000120	0.3660
	06/15/2016	40133877004	<0.200	<0.00013	0.00043	0.000170	0.000068	1.3450
	08/10/2016	40136543004	<0.200	<0.00013	0.00047	0.000240	0.000140	1.1369
	10/05/2016	40139741004	<1.000	<0.00013	0.00045	0.000340	<0.000040	0.9710
	12/21/2016	40143755005	<0.500	<0.00013	0.00040	0.000220	0.000089	1.0182
	03/10/2017	40146662004	<0.100	<0.00013	0.00054	0.000260	0.000250	0.1570
	06/02/2017	40151013004	<0.100	<0.00013	0.00032	<0.001400	<0.000200	0.4970
LS-106	02/18/2016	40128408004	<0.200	<0.00010	0.00890	0.000280	0.002100	1.5740
	04/05/2016	40130257005	<0.200	<0.00010	0.01270	0.000420	0.003500	2.1900
	06/15/2016	40133877005	<0.200	<0.00013	0.00440	0.000210	0.001200	1.0780
	08/10/2016	40136543005	<1.000	<0.00013	0.00250	0.000094	0.000530	1.1750
	10/05/2016	40139741005	<0.500	<0.00013	0.02170	0.000590	0.005400	3.9750
	12/21/2016	40143755006	<0.500	<0.00013	0.00630	0.000170	0.001600	1.3150
	03/10/2017	40146662005	<0.500	<0.00013	0.02300	0.000420	0.005400	2.0200
	06/02/2017	40151013005	<0.500	<0.00013	0.00380	<0.001400	0.001200	0.1640
LS-107	02/18/2016	40128408005	<0.200	<0.00010	0.00100	0.000220	0.000310	0.4850
	04/05/2016	40130257006	<0.200	<0.00010	0.00062	0.000250	0.000055	0.6840
	06/15/2016	40133877001	<0.200	<0.00013	0.00063	0.000540	0.000110	0.1750
	08/10/2016	40136543001	<0.200	<0.00013	0.00080	0.000590	0.000048	0.3320

**Weston Disposal Site #3**  
**Table 2. Weston Disposal Site No. 3 Landfill: Appendix IV Analytical Results**

**Date Range: 02/18/2016 to 10/01/2017**

			F, tot, mg/L	Hg, tot, mg/L	Li, tot, mg/L	Mo, tot, mg/L	Pb, tot, mg/L	Ra 226+228, pCi/L
LS-107	10/05/2016	40139741006	<0.100	<0.00013	0.00052	0.000410	<0.000040	0.4230
	12/20/2016	40143755001	<0.100	<0.00013	0.00100	0.000480	0.000350	1.2450
	03/10/2017	40146662006	<0.100	<0.00013	0.00071	0.000210	0.000100	0.1840
	06/02/2017	40151013006	<0.100	<0.00013	0.00054	<0.001400	<0.000200	0.6110

**Weston Disposal Site #3**  
**Table 2. Weston Disposal Site No. 3 Landfill: Appendix IV Analytical Results**

Date Range: 02/18/2016 to 10/01/2017

Well Id	Date Sampled	Lab Id	Sb, tot, mg/L	Se, tot, mg/L	Tl, tot, mg/L
LS-100	02/18/2016	40128408001	<0.000066	0.00033	0.000047
	04/05/2016	40130257002	<0.000034	0.00031	<0.000012
	06/15/2016	40133877003	<0.000073	0.00045	<0.000140
	08/10/2016	40136543003	<0.000073	0.00037	0.000280
	10/05/2016	40139741002	<0.000073	0.00071	<0.000140
	12/21/2016	40143755003	0.000240	0.00140	<0.000140
	03/10/2017	40146662002	0.000200	0.00044	0.000200
	06/02/2017	40151013002	<0.000150	0.00077	0.000290
LS-101	02/18/2016	40128408002	<0.000066	0.00025	<0.000018
	04/05/2016	40130257003	<0.000034	0.00024	<0.000012
	06/15/2016	40133877002	<0.000073	0.00034	<0.000140
	08/10/2016	40136543002	<0.000073	<0.00021	0.000930
	10/05/2016	40139741003	<0.000073	<0.00021	<0.000140
	12/21/2016	40143755002	0.000370	0.00025	<0.000140
	03/10/2017	40146662003	<0.000073	0.00042	<0.000140
	06/02/2017	40151013003	<0.000150	0.00044	<0.000140
LS-105	02/18/2016	40128408003	0.000099	0.00072	0.000024
	04/05/2016	40130257004	<0.000034	0.00015	0.000015
	06/15/2016	40133877004	<0.000073	0.00056	<0.000140
	08/10/2016	40136543004	0.000420	0.00073	0.000180
	10/05/2016	40139741004	<0.000073	0.00070	<0.000140
	12/21/2016	40143755005	0.000150	0.00081	<0.000140
	03/10/2017	40146662004	<0.000073	0.00051	<0.000140
	06/02/2017	40151013004	<0.000150	0.00044	<0.000140
LS-106	02/18/2016	40128408004	0.000081	0.00097	0.000080
	04/05/2016	40130257005	0.000096	0.00047	0.000140
	06/15/2016	40133877005	<0.000073	0.00140	<0.000140
	08/10/2016	40136543005	<0.000073	0.00100	<0.000140
	10/05/2016	40139741005	<0.000150	0.00450	<0.000290
	12/21/2016	40143755006	0.000170	0.00190	<0.000140
	03/10/2017	40146662005	<0.000360	0.00470	<0.000710
	06/02/2017	40151013005	<0.000150	0.00180	<0.000140
LS-107	02/18/2016	40128408005	<0.000066	0.00031	0.000027
	04/05/2016	40130257006	<0.000034	0.00021	<0.000012
	06/15/2016	40133877001	<0.000073	0.00025	<0.000140
	08/10/2016	40136543001	<0.000073	<0.00021	0.000620

**Weston Disposal Site #3**  
**Table 2. Weston Disposal Site No. 3 Landfill: Appendix IV Analytical Results**

---

**Date Range: 02/18/2016 to 10/01/2017**

			<b>Sb, tot, mg/L</b>	<b>Se, tot, mg/L</b>	<b>Tl, tot, mg/L</b>
LS-107	10/05/2016	40139741006	<0.000073	0.00021	<0.000140
	12/20/2016	40143755001	0.000270	0.00041	0.000410
	03/10/2017	40146662006	<0.000073	<0.00021	<0.000140
	06/02/2017	40151013006	<0.000150	<0.00032	<0.000140



## Figures

Y:\GIS\Projects\161660\MXD\2017\agwincart\Figure 1\_GW\_Samp\_Well\_Loc\_Weston\_DS3.mxd Author: slolzsd Date/Time: 1/29/2018, 5:10:06 PM

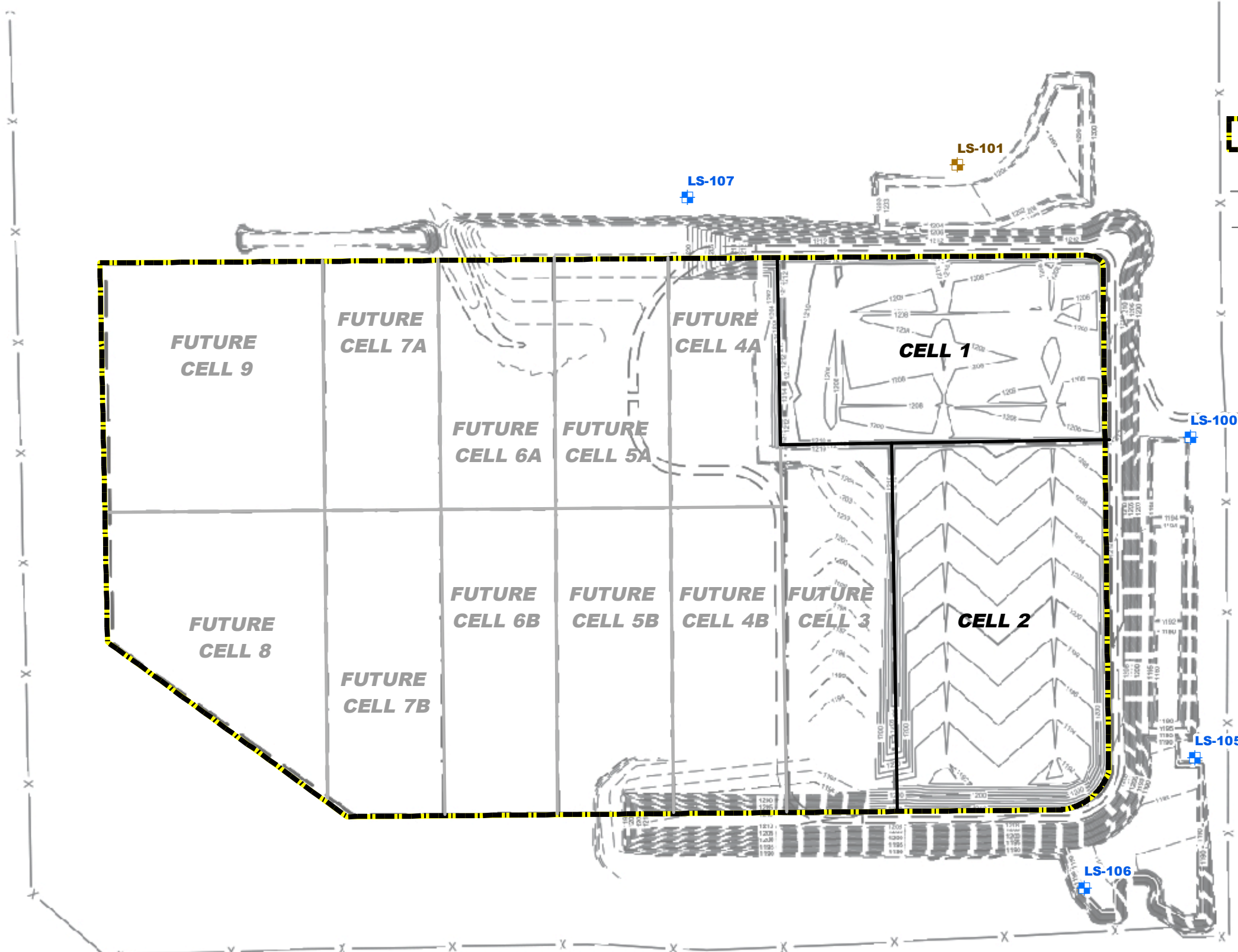

- CCR RULE DOWNGRADE MONITORING WELL LOCATION
- CCR RULE UPGRADIENT MONITORING WELL LOCATION
- WESTON DISPOSAL SITE NO. 3 LANDFILL
- SURFACE ELEVATION CONTOUR (DASHED WHERE INFERRED)
- FENCE LINE

**GROUNDWATER SAMPLING WELL LOCATION MAP**

2017 ANNUAL GROUNDWATER MONITORING AND  
CORRECTIVE ACTION REPORT  
WESTON DISPOSAL SITE NO. 3 LANDFILL  
TOWN OF KNOWLTON, WISCONSIN

PROJECT NO: 67985

FIGURE NO: 1

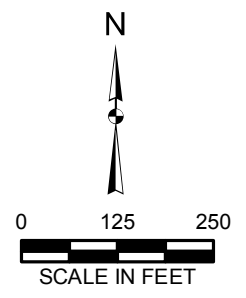

- NOTES:**
1. THE TOPOGRAPHIC BASE MAP HAS BEEN CREATED FROM AERIAL PHOTOGRAPHY AND LIDAR ACQUISITION BY AERO-METRIC, INC., SHEBOYGAN, WI. DATE FLOWN: NOVEMBER 5, 2010.
  2. HORIZONTAL DATUM IS REFERENCED TO WISCONSIN STATE PLANE COORDINATE SYSTEM, CENTRAL ZONE, NORTH AMERICAN DATUM (NAD 83/2007), US SURVEY FEET.
  3. VERTICAL DATUM IS NORTH AMERICAN VERTICAL DATUM 1988 (NAVD88). CONTOUR INTERVAL IS 2 FEET.

DRAWN BY/DATE:  
SDS 1/17/18  
REVIEWED BY/DATE:  
GRL 1/17/18  
APPROVED BY/DATE:  
GRL 1/29/18



**OBG**

THERE'S A WAY

